

Spe

Designed by: S

Plans for p

Wingspan: 26"

Length: 21"

Flying weight: 10 oz'

Speedy

Shaun Frank (3DMON)
Personal use only.

Battery: 3s 1300mah lipo
Motor: 3000kv outrunner
Prop: 4.5x4.5

Hole
speed c
wire

Ailer

)
for
control
s

on



Each line represents 1"

The motor attaches
to one of these pieces
This assembly screws
to the firewall attached
to the plane allowing
you to change between
different motors.

Motor mount and control horns
made from 1/16" plywood.

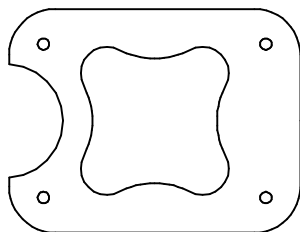
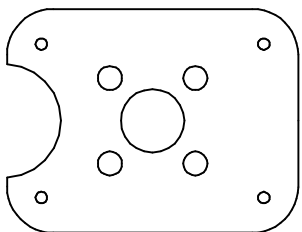
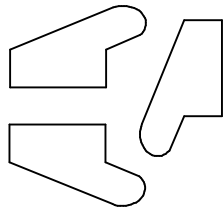
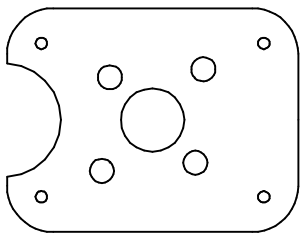

This piece gets
glued to the plane

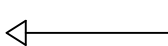

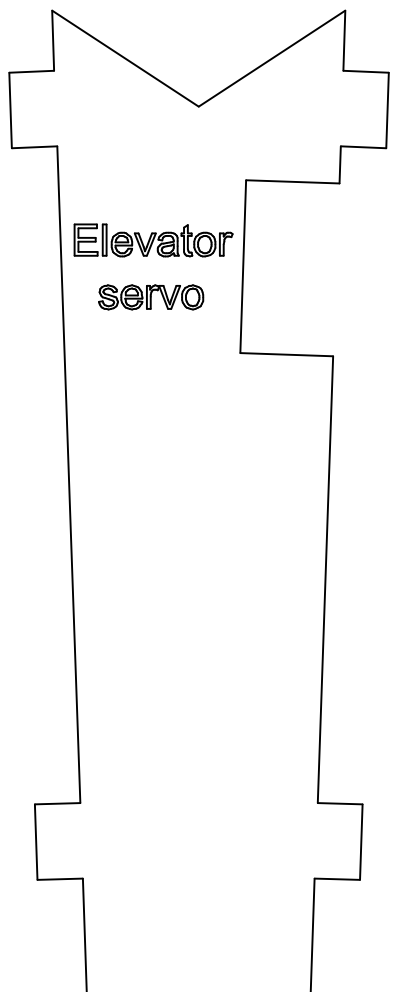
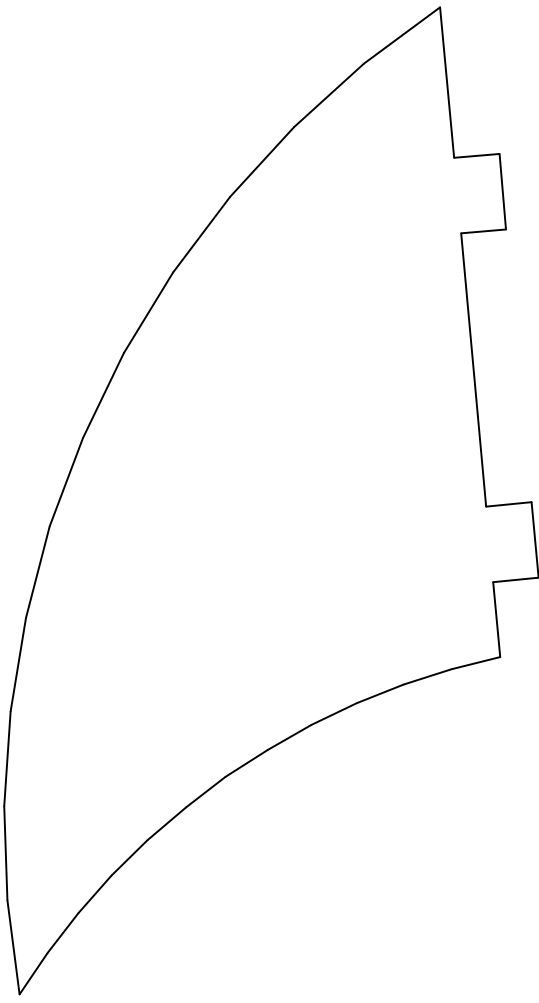
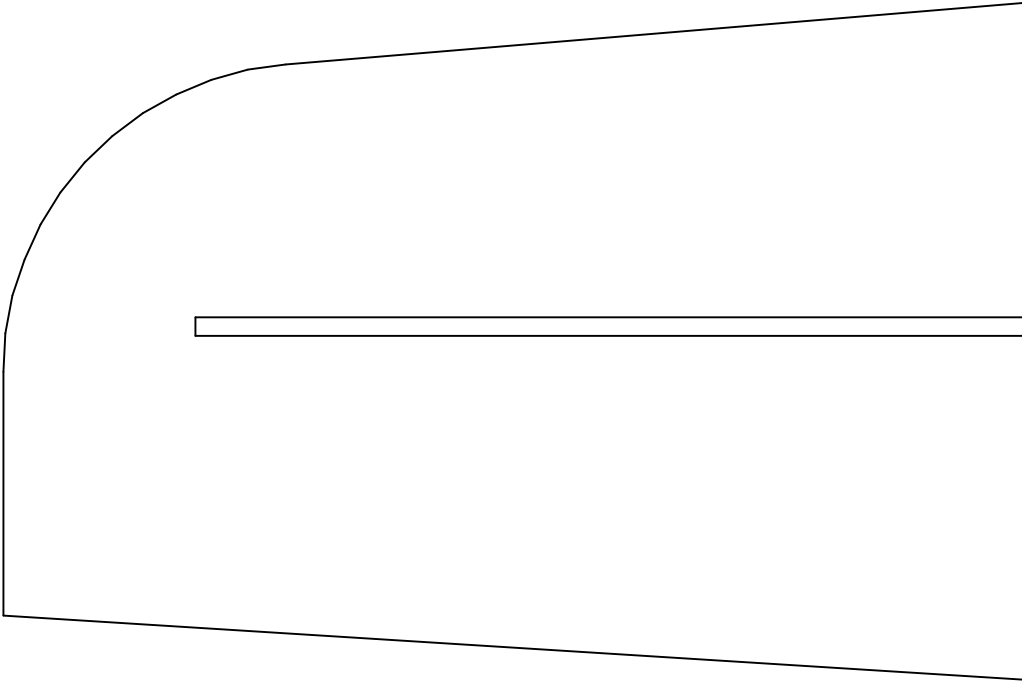

Sen

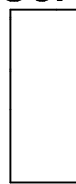

C.C.



.156 carb

.196 carb



VO

g.

on spar

on spar

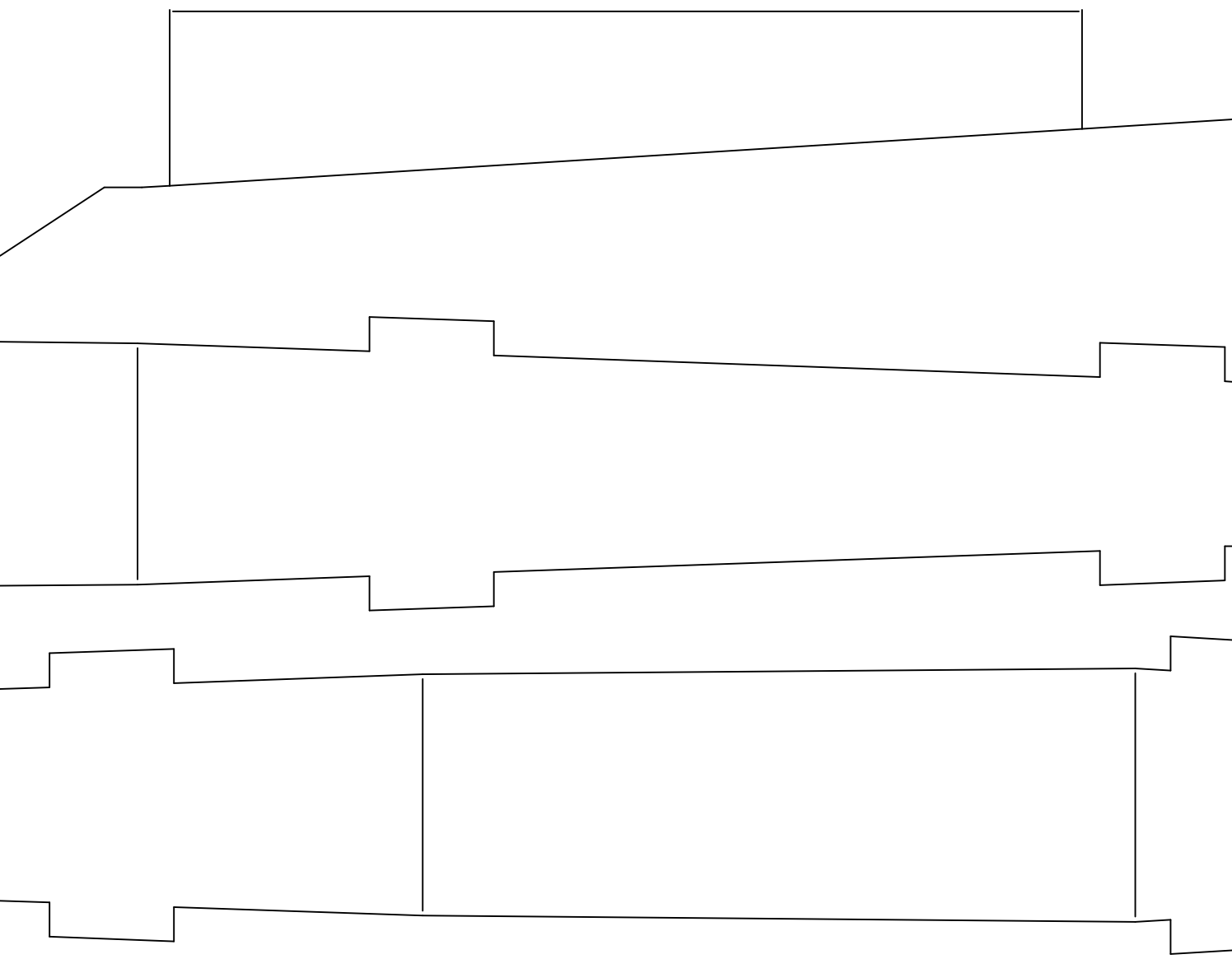

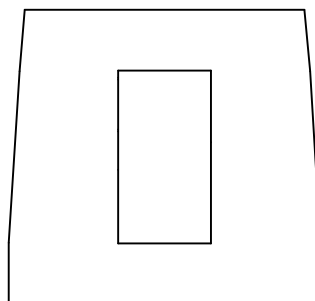
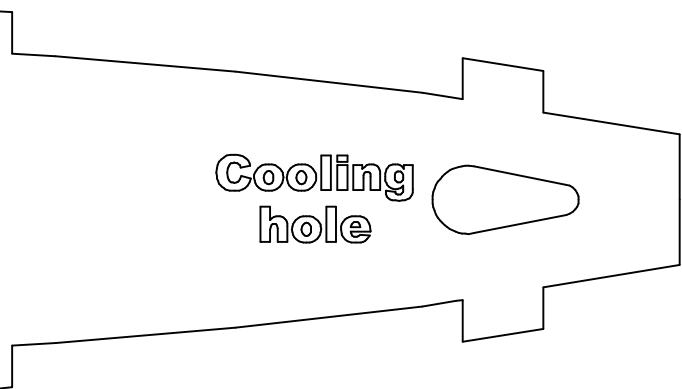
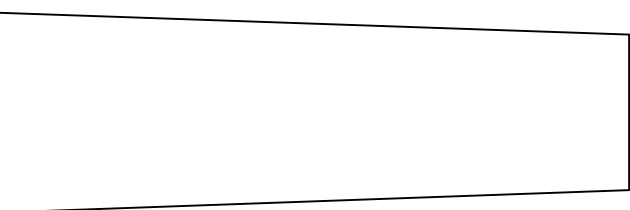
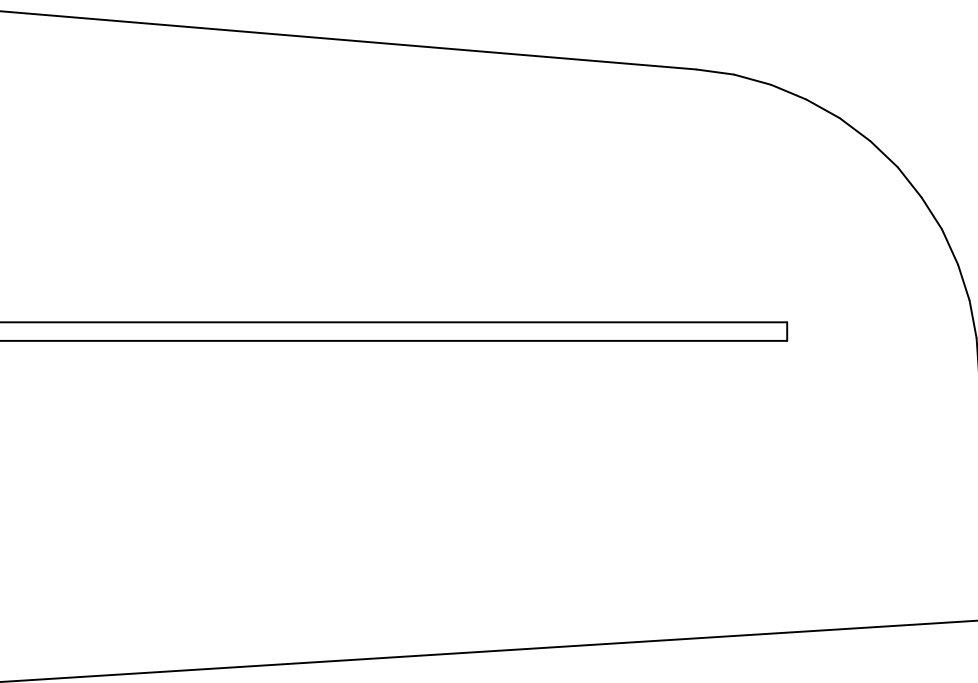

Optional
servo risers

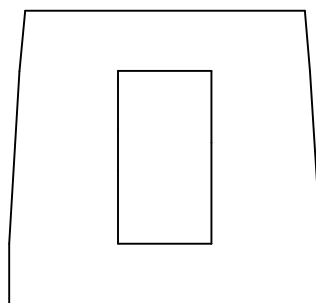

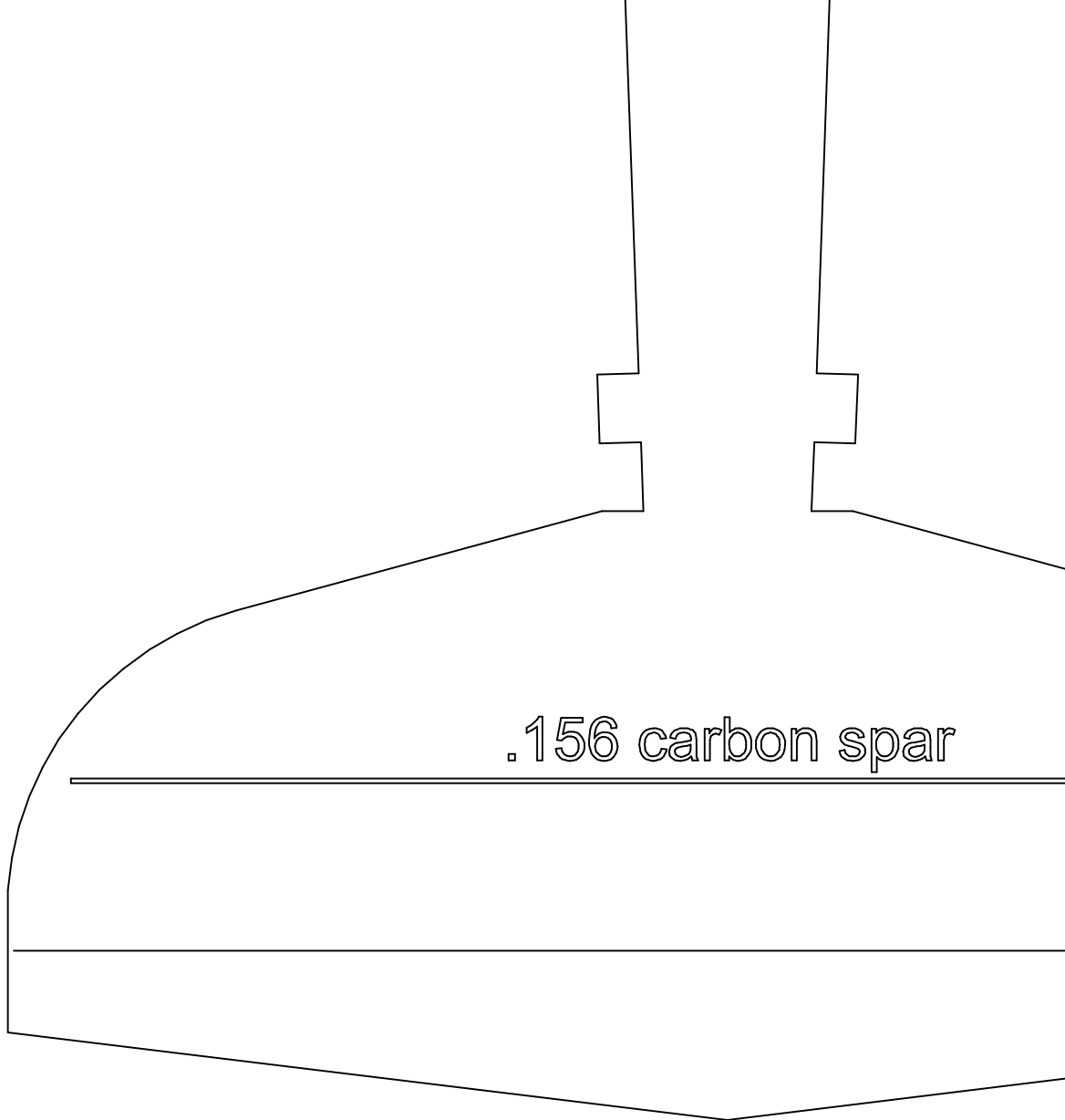

.156 carbon spar

